

RECREATION • INVESTMENT

344± Acres in Neshoba County, MS



\$775,000



**JAKE
CALLENDER**
REALTOR®

Office: 601.898.2772
Cell: 601.955.2559
Jake@TomSmithLand.com



Expect More. Get More.

A Real Estate Expert You Can Trust

TomSmithLandandHomes.com

Information is believed to be accurate but not guaranteed.





This 344± acre tract in Neshoba County, MS offers an exceptional opportunity for anyone seeking a premier recreational and investment property. With a well-maintained internal road system, navigating the property is effortless, allowing easy access to all corners of the land.

The tract features a diverse mix of timber, including both pine and hardwood stands that provide long-term investment potential as well as excellent wildlife habitat. Established food plots are already in place, creating ideal hunting locations throughout the property. Deer, turkey, and other native wildlife are abundant, making this a standout destination for outdoor enthusiasts.

The combination of mature timber, habitat diversity, and well-planned access makes this property well-suited for recreation, timber investment, or a private retreat. Whether you're looking for a hunting property, long-term land investment, or a place to escape into the outdoors, this 344± acres in Neshoba County is one you won't want to miss. Call Jake Callender with Tom Smith Land and Homes to schedule your private showing today!

A Real Estate Expert *You Can Trust!*

JAKE CALLENDER
REALTOR®

O: 601.898.2772 C: 601.955.2559

Jake@TomSmithLand.com

TomSmithLandandHomes.com



Expect More. Get More.





A Real Estate Expert
You Can Trust!

JAKE CALLENDER

REALTOR®

O: 601.898.2772 C: 601.955.2559

Jake@TomSmithLand.com

TomSmithLandandHomes.com



Expect More. Get More.

Information is believed to be accurate but not guaranteed.





A Real Estate Expert You Can Trust!

JAKE CALLENDER

REALTOR®

O: 601.898.2772 C: 601.955.2559

Jake@TomSmithLand.com

TomSmithLandandHomes.com



Expect More. Get More.



Information is believed to be accurate but not guaranteed.



A Real Estate Expert
You Can Trust!

JAKE CALLENDER

REALTOR®

O: 601.898.2772 C: 601.955.2559

Jake@TomSmithLand.com

TomSmithLandandHomes.com



Expect More. Get More.

Information is believed to be accurate but not guaranteed.





A Real Estate Expert
You Can Trust!

JAKE CALLENDER

REALTOR®

O: 601.898.2772 C: 601.955.2559

Jake@TomSmithLand.com

TomSmithLandandHomes.com



Expect More. Get More.



Information is believed to be accurate but not guaranteed.

AERIAL MAP



[Land ID Interactive Map Link](#)

A Real Estate Expert
You Can Trust!

JAKE CALLENDER
REALTOR®

O: 601.898.2772 C: 601.955.2559

Jake@TomSmithLand.com

TomSmithLandandHomes.com



Expect More. Get More.



Information is believed to be accurate but not guaranteed.

TOPOGRAPHY & OWNERSHIP MAP

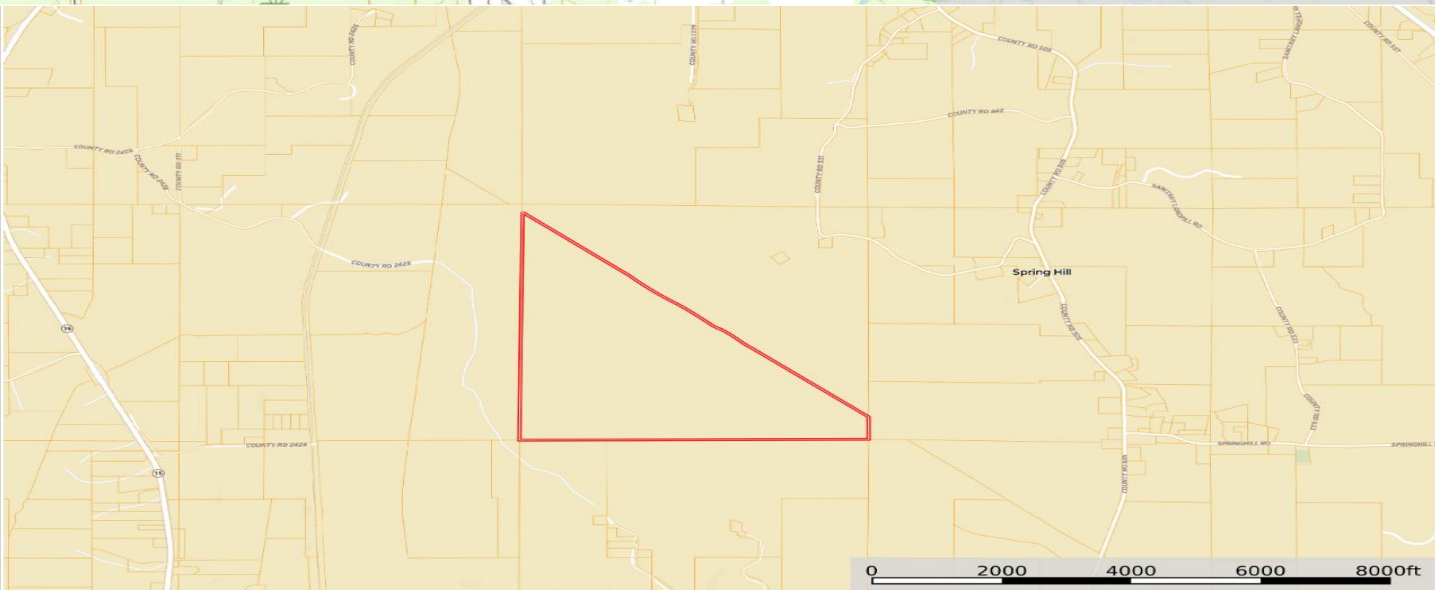
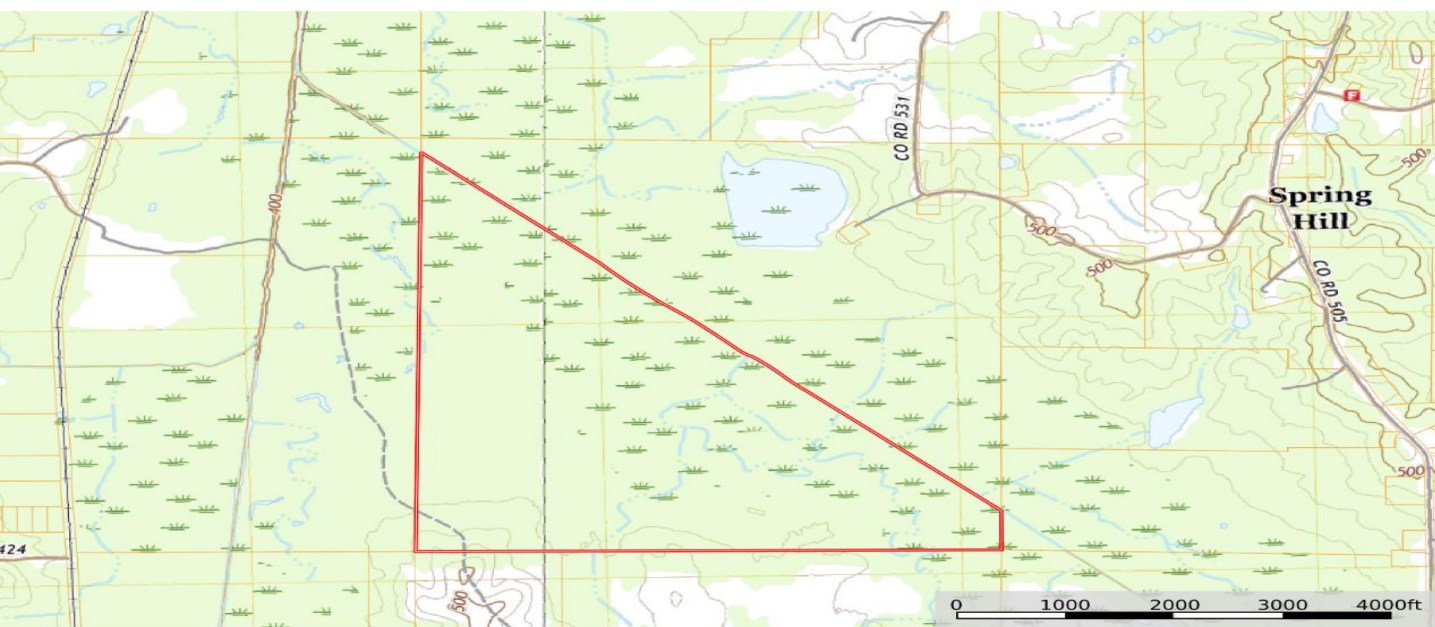

A Real Estate Expert
You Can Trust!

JAKE CALLENDER
REALTOR®

O: 601.898.2772 C: 601.955.2559

Jake@TomSmithLand.com

TomSmithLandandHomes.com

**Tom
Smith**
**LAND AND
HOMES**

Expect More. Get More.

2011-2025
BEST
BROKERAGES

Information is believed to be accurate but not guaranteed.

DIRECTIONAL MAP

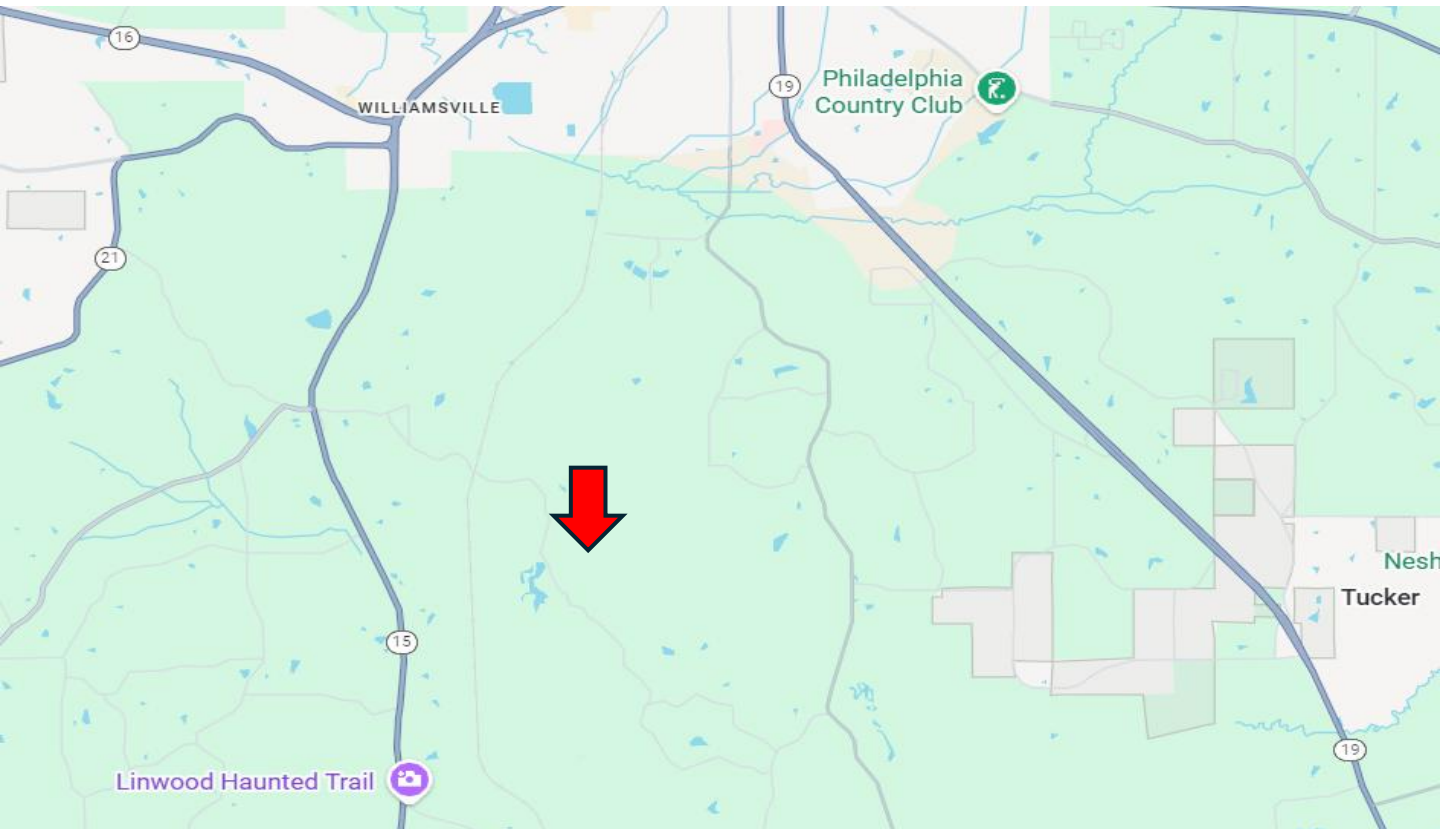

DIRECTONS FROM THE INTERSECTION OF E Main St AND Range Ave.: Continue onto Rd 505 for 4.7 miles. Turn right onto Co Rd 347 and go straight for 0.5 miles. Turn right onto Co Rd 527 and go straight for 1.1 miles. Turn right onto Co Rd 1327 and go straight for 1.6 miles and the property will be straight ahead. [Google Map Link](#)

A Real Estate Expert
You Can Trust!

JAKE CALLENDER

REALTOR®

O: 601.898.2772 C: 601.955.2559

Jake@TomSmithLand.com

TomSmithLandandHomes.com



Expect More. Get More.

